

# LOCATION PLAN

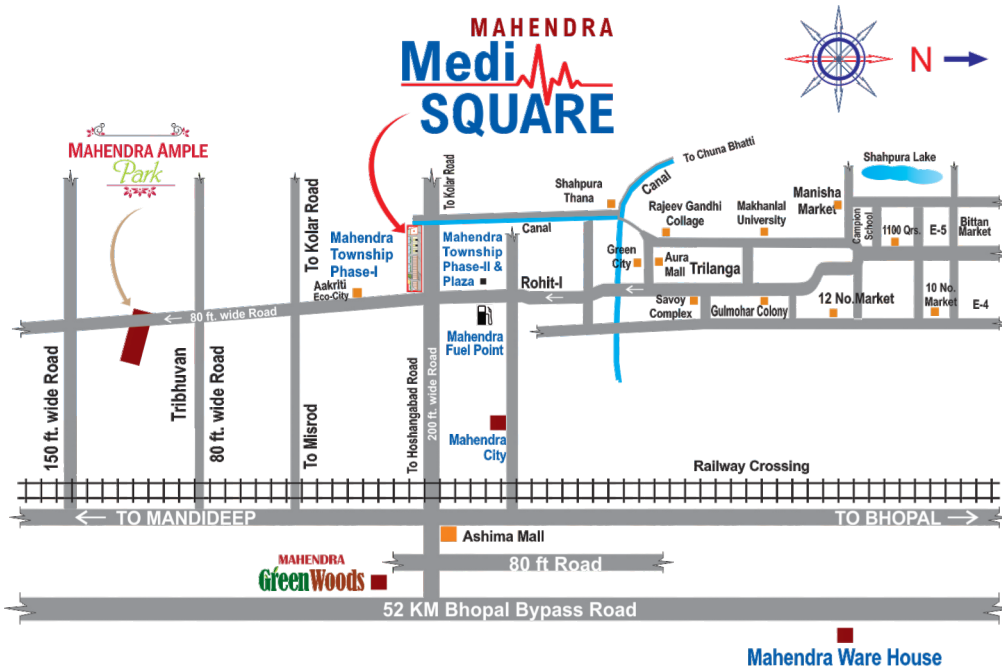

Site Address : **Mahendra Medi Square**, Mahendra Township Phase-I  
E-8 Extn. Bawadia Kalan Bhopal. Tel.: 7024143668, 8085513422



Architect :  
**PAHADE & DASGUPTA ASSOCIATES**  
Ph.: 0755-4275874

Member  
**CREDAI**  
Confederation of Real Estate  
Developers' Associations of India

Project By



154, Mahendra Complex, Zone- I, M.P.Nagar, Bhopal-11  
Tel.: **0755-2551172, 3013668**

E-mail: mahendrabuilders@rediffmail.com • www.mahendrabuilders.in  
f/mahendrabuilders t/Mbindia

All perspectives and dimensions are indicative and may change. Developer reserve the right to amend plans and specifications as may be required. Any information contained in the brochures is subject to change without prior notice at the sole discretion of the developer and can not form part of any agreement. All furniture and extra accessories in plans have aesthetic sense only and does not cover the part of the building supply. This brochure is purely conceptual and not a legal offering. All visual photograph are artists impressions.

Alp Graphics : 9827058525, 05

# MAHENDRA Medi SQUARE



**YOUR HAPPINESS IS A REFLECTION OF YOUR HEALTH**

## AMENITIES

- Shop & Halls of Different Sizes.
- Attached Toilet with Halls.
- Address for all kind of medical facilities at one place.
- At a prime location of 200 ft. Road, E-8 Extension Bawadia Kalan.
- Connectivity to other area such as Kolar, Hoshangabad Road.

MAHENDRA  
**Medi**  
**SQUARE**

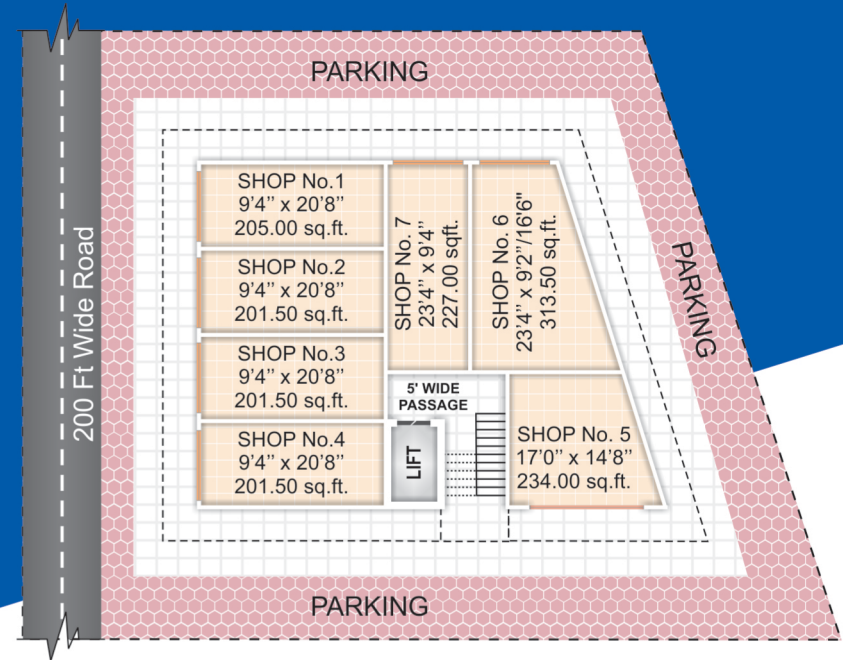

## GROUND FLOOR PLAN

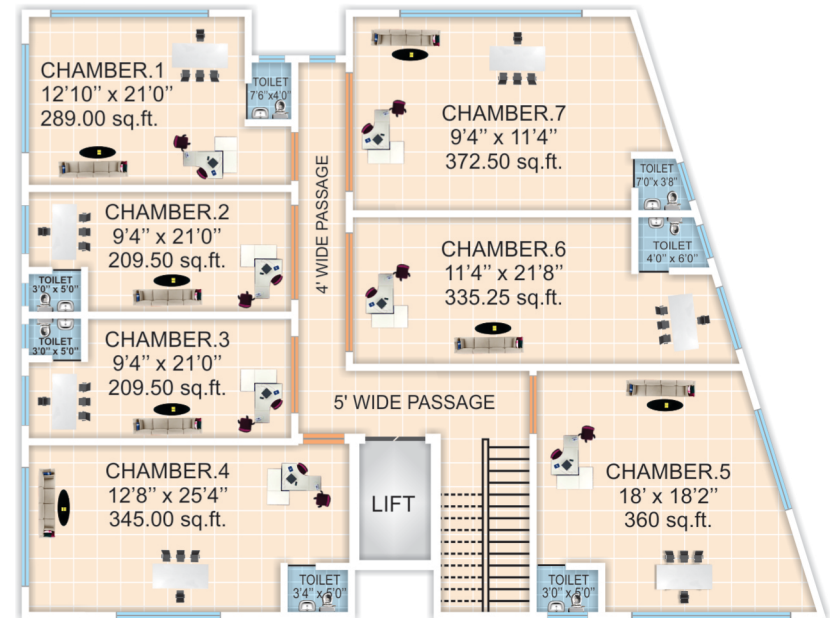

## 1st, 2nd, 3rd FLOOR PLAN