

LOCATION PLAN



MAHENDRA Green Woods

Extension

A Signature for your lifestyle

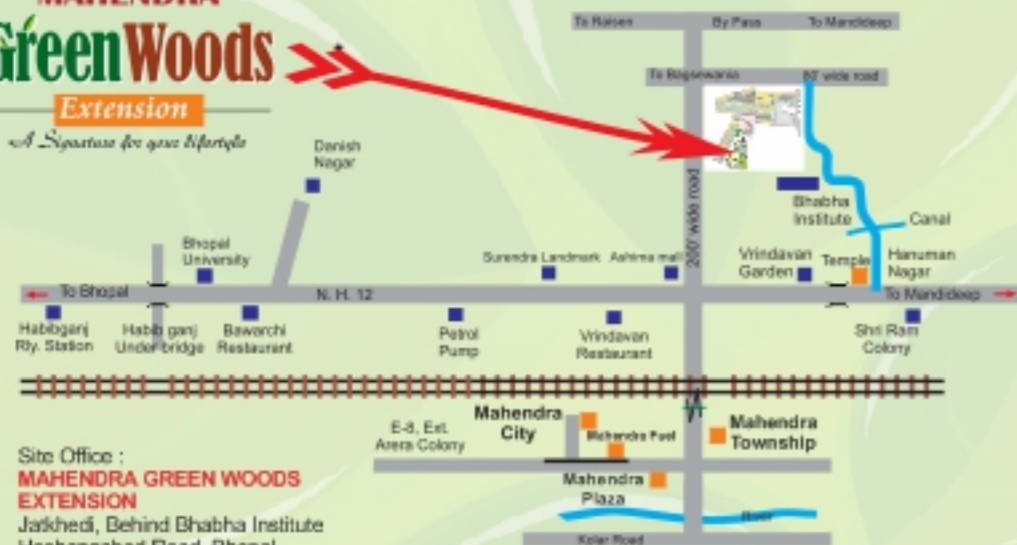

Site Office :
**MAHENDRA GREEN WOODS
EXTENSION**
Jaskhedli, Behind Bhabha Institute
Hoshangabad Road, Bhopal
Ph.: 9303358688

AN ISO CERTIFIED COMPANY



Mahendra Complex, 154, Zone-I M.P. Nagar, Bhopal. Ph.: 0755-2551172,3013668
Website : www.mahendrabuilders.com, E-mail : mahendrabuilders@rediffmail.com



Architect :
PARADE & DASGUPTA ASSOCIATES
Ph.: 0755-4275874

All perspectives and dimensions are indicative and may change. Developer reserves the right to amend plans and specifications as may be required. Any information contained in the brochure is subject to change without prior notice at the sole discretion of the developer and can not form part of any agreement. All furniture and extra accessories in plans have aesthetic value only and does not cover the part of the building cost. This brochure is purely conceptual and not a legal offering. All visual photographs are artist's impression.



An ISO 9001 : 2008
Certified company

MAHENDRA Green Woods

Extension

A Signature for your lifestyle

MAHENDRA Green Woods

Extension

A Signature for your lifestyle

PROJECT

After the popular success of Mahendra Township phase-I & II and Mahendra City, Mahendra Builders & Developers present you with a "State of the Art" lifestyle concept of a prime location of Bhopal, named "Mahendra Green Woods Extension".

PROJECT HIGHLIGHTS

- Pollution free atmosphere.
- Round the clock Security.
- Covered campus situated on a near 80 & 200 feet wide master plan road.
- Club house & Swimming pool Completed.
- Beautiful land scalped open spaces.
- Garden with children's playground.
- Under ground cabling and stylish external lighting.
- Large shopping center.
- Exclusive front elevation.
- Loan facility available.

PROMOTERS

Mahendra Builders, a professionally managed group in the Real Estate Industry, is a rare combination of vision, conceptualization, strength and quality consciousness. resource management is one of it's proud skills. It has already build a strong pillar of popularity because of it's attention and endurance to the basic needs paralleled with the luxurious desires of the common man. The Mahendra Township Phase - I & Phase- II and Mahenders City, Mahendra Plaza in E-8 Extn., Arera Colony have become the land mark of south Bhopal & Mahendra Green Woods at Jatkhedi, Hashangabad Road, Bhopal.

They are also proud to presents
154, Mahendra Complex
at Zone - I, M.P. Nagar, Bhopal

Main Entrance Gate



Actual Photograph

MAHENDRA Life Style



Club House & Swimming Pool Completed





MAHENDRA
Platinum

MAHENDRA
Gold

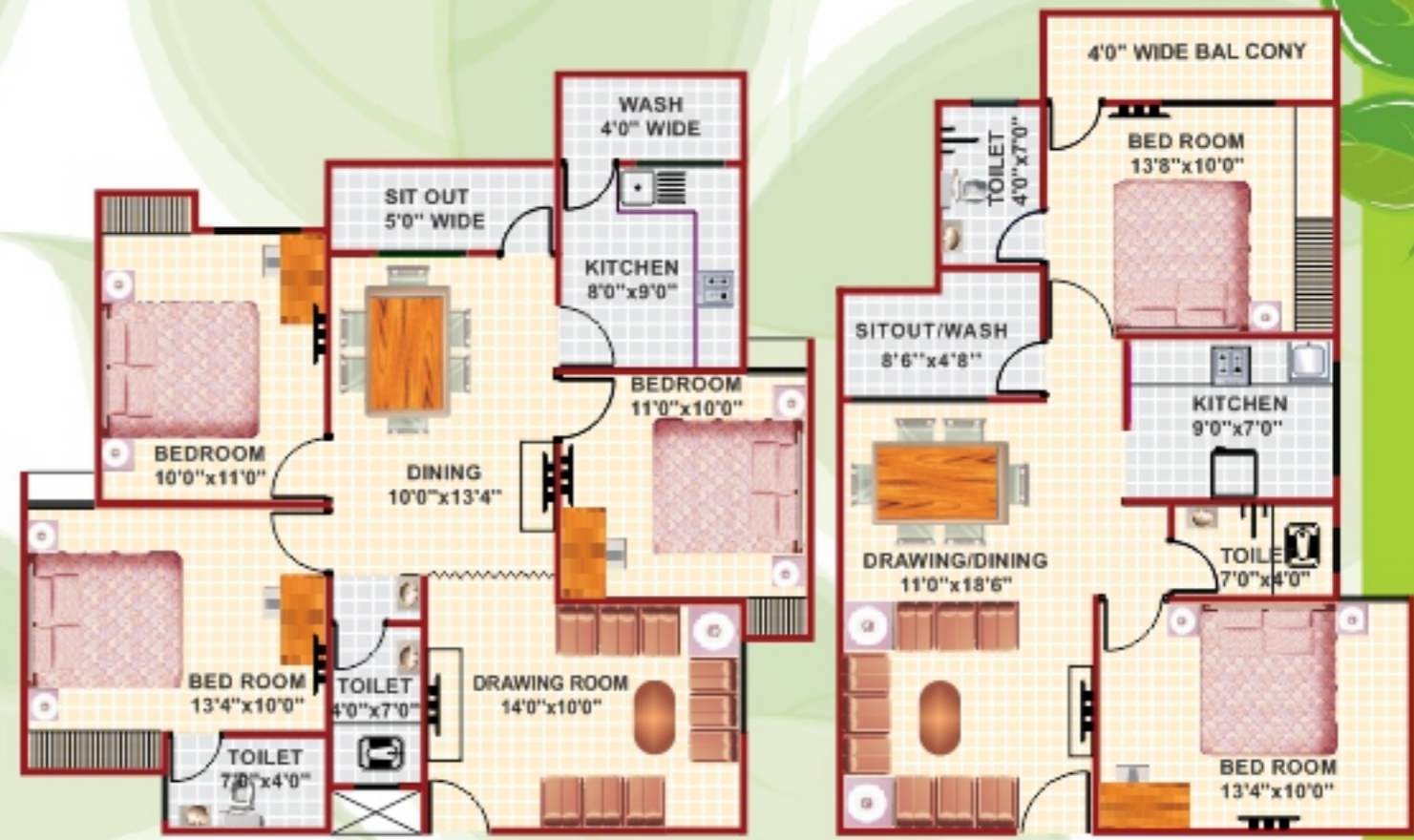

3-BHK FLAT

2 BHK FLAT

SBU AREA 1242 SQ. FT.

SBU AREA 1019 SQ. FT.

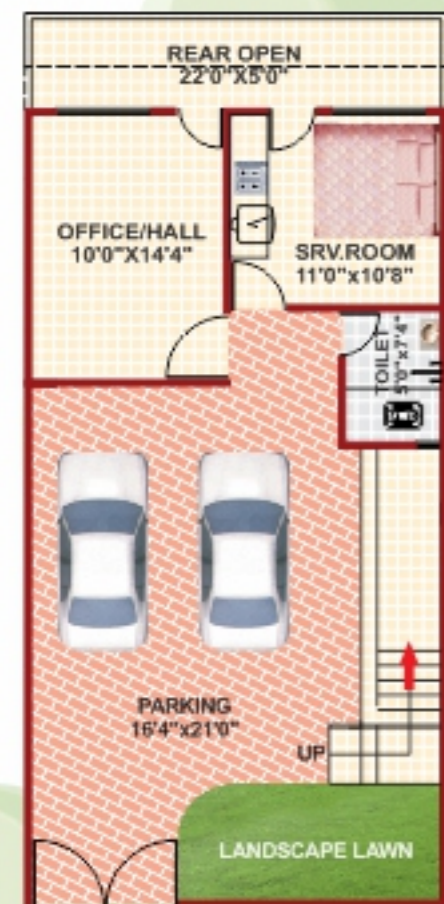

PARKING FLOOR PLAN

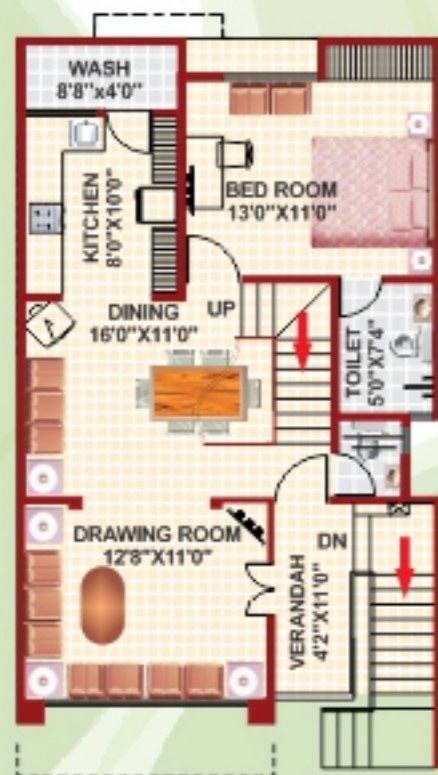

GROUND FLOOR PLAN



FIRST FLOOR PLAN

SBU AREA 3695 SQ. FT.

Amaltas

MAHENDRA
Green Woods
Extension
A Signature for your Lifestyle





MAHENDRA
Green Woods
Extension
A Signature for your Lifestyle

SPECIFICATIONS

- | | |
|-----------------|--|
| Structure | : R.C.C. Framed. |
| Walls | : Brick masonry. |
| Flooring | : Vitrified tile 2'x2' in Drawing cum Dining and all Bedrooms & Ceramic tiles in other spaces. |
| Toilets | : Glazed tile upto 7ft. with matching ceramic wares and C.P. fittings, geyser power point in toilet and kitchen. |
| Kitchen | : Black Granite stone platform, stainless steel sink, glazed tiles dado up to 2 ft. from platform. |
| Door | : Factory made flush doors with Wooden frames, |
| Window | : Powder coated Aluminum section, sliding windows with fixed M.S. grill. |
| Water supply | : Concealed water lines with individual overhead water tank. |
| Electrification | : Concealed copper wiring with modular switches, |
| Painting | : External walls finished with weather proof acrylic paint & internal wall with oil bound distemper, Enamel paint on steel & wood works. |
| P.O.P. | : Cornice & Beading in Drawing, Dining & All Bedrooms. |